

1L22 1L32

MIYOTA

**Size**  
<line> 6 3/4 x 8'''

**Height**  
<mm> 2.28 (1L22 2.15)

**Accuracy**  
<per Month> ±20 sec

**Battery Life**  
5 years (1L32 3 years)

Battery consumption could be minimum by pulling out the stem (=Power-Saving)

**Balance Weight**  
<μN.m> Minute 0.40  
Second 0.07

Featured by Shock Detection

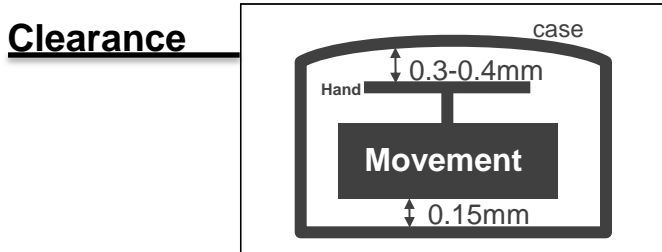

**Original Package**  
1,000 pcs

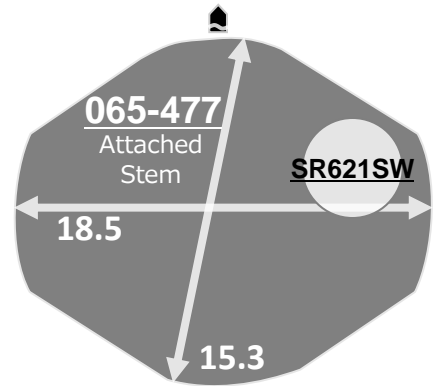

\*Battery of 1L22 : SR616SW

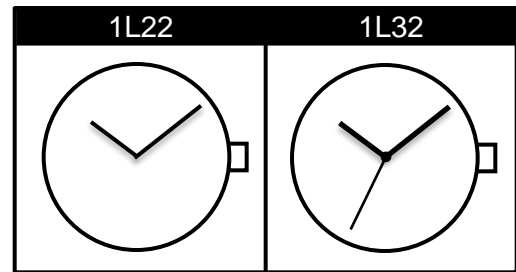

High Hand Ver.  
1L26  
1L36

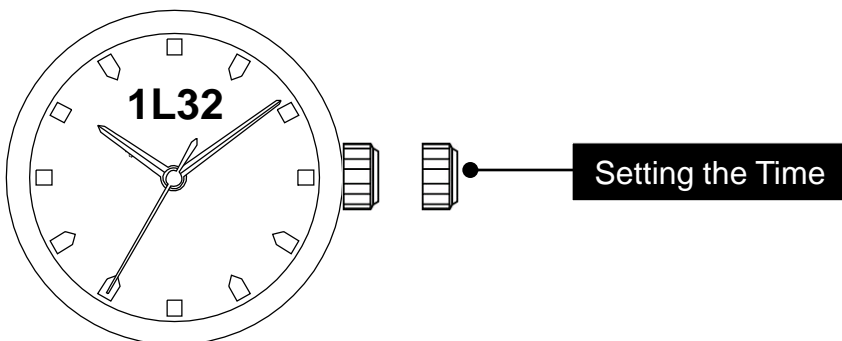

CAL. 1L/MXX  
 MOVEMENT SPECIFICATIONS  
**CAL. 1L/MXX SERIES ANALOG QUARTZ MOV'T**  
 BY CITIZEN WATCH CO., LTD. JAPAN  
**NEW FLAT RANGE**  
 MANUFACTURED IN JAPAN

**1. BASIC SPECIFICATION**

(1) CAL. NO.

\*TO CONFIRM WITH MOV'T DRAWING ATTACHED

CALIBRE	1L22	1L32	1L12	1L02	1M12	1M02
Ligne	6 X 8		6 X 8		10 1/2	
Overall length	15.3 × 18.2		15.3 × 18.2		23.7 × 22.6	
Case fitting length	15.3 × 17.8		16.1 × 17.8		23.3 × 22.6	
Total height	2.15mm	2.28mm	2.71mm	2.94mm	2.71mm	2.94mm
Hands	2	3	3			
Date	X		○	○	○	○
Day of Week	X		X	○	X	○
Battery life	5 Year	3 Year	3 Year			
Battery	SR616SW	SR621SW	SR621SW			

(2) Time standard

Type of quartz : Tuning fork type quartz crystal

Frequency : 32,768Hz

Accuracy : **+/-20 s/month** worn under normal circumstances

(3) Battery installed

Type of battery : See above: JAPAN-MADE

(4) Others

Driving systems : Two-pole stepping motor

Number of Jewel : No(0) jewel

(5) Additional Mechanisms & Features:

**Quick Day/Date Change by turning crown(\*1L12/02/1M12/02)**

**Bilingual Day of Week(\*1L02/1M02)**

**Powercell Saving Reset Mechanism(PSRM)**

**Second hand stopping at optional position**

**Over-loading Compensation Device(OLCD)**

**Digital Frequency Control(DFC) for time adjustment**

(6) Balanceable weight of hand

Minute hand Max. 0.4  $\mu$ N·m

Second hand Max. 0.07  $\mu$ N·m

## 2. SEPARATED PARTS

CAL. 1L/MXX

	1L22	1L32	1L12	1L02	1M12	1M02
Hour Wheel	075-446	075-446	075-455	075-454	075-455	075-454
Dial Washer	078-040	078-040				
Setting Stem	065-477	065-477	065-505	065-505	065-505	065-505

## 3. Others

### \* Measurement of time rate

The unit(gate) time of measurement must be set at "10s " or integer fold value of 10s owing to the DFC system, and the measurement must be performed in the form of complete watch.

### \* Marking on movement

NO(0) JEWEL  
(CAL. NO.)  
MIYOTA CO., JAPAN

### \* Typical clearance

Mov't - Caseback	minimum 150 $\mu\text{m}$ or more
Top of hands - Glass	300 - 400 $\mu\text{m}$ *

\* depending and subject to the glass and case structure, and hand length

### \* Interchangeability of appearance components:

Dial Foot position & the diameter	same as Cal. 20/21/6L/6M series*
Day/Date window position	same as Cal. 20/21/6L/6M series*
Hands	same as Cal. 2035/20/21/6L/6M series

\*respectively plain to plain, date to date and d/d to dd

### \*How to set time and day/date:

Day/Date	-----	Pull out crown to the first click position, then: turn crown clockwise for Weekday turn crown counter-clockwise for Date
Time	-----	Pull out crown to the second click position and turn crown until the time is set correctly**

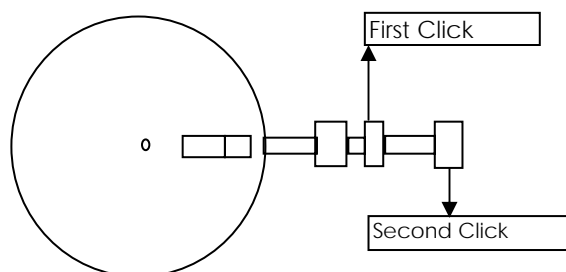

\*\*Time Setting of CAL.1L22/32  
: at the first click position

*This specifications might be changed without prior notice.*

This drawing is provisional and subject to our reconfirmation and/or revision without notice.

\*\*\* TIPW 1L02 (01) \*\*\* (2100 1121 ) 00-06-26

DH1~DH2=16171 (±20)

Coordinates			
Mark	X	Y	R
GM	0	0	—
h1	7270	4825	350
h2	-7270	4825	350
h3	-7270	-4825	350
h4	7557	-4025	325
DH1	-7900	-3000	—
DH2	8294	-1900	—
a1	2793	7550	500
a2	6600	5539	300
a3	7200	4787	300
a4	8299	3350	300
a5	8900	1632	300
a6	8900	-1632	300
a7	8299	-3350	300
a8	7200	-4787	300
a9	6600	-5539	300
a10	2793	-7550	500
a11	-2793	-7550	500
a12	-6600	-5539	300
a13	-7200	-4787	300
a14	-8299	-3350	300
a15	-8900	-1632	300
a16	-8900	1632	300
a17	-8299	3350	300
a18	-7200	4787	300
a19	-6600	5539	300
a20	-2793	7550	500
f21	5788	7505	1500
f22	5788	-7505	1500
f23	-5788	-7505	1500
f24	-6854	6800	1500

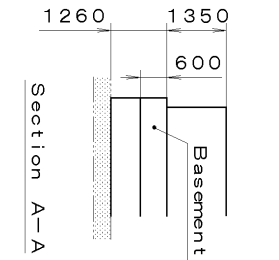
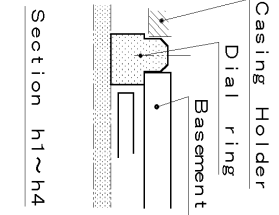
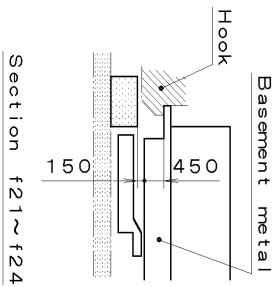
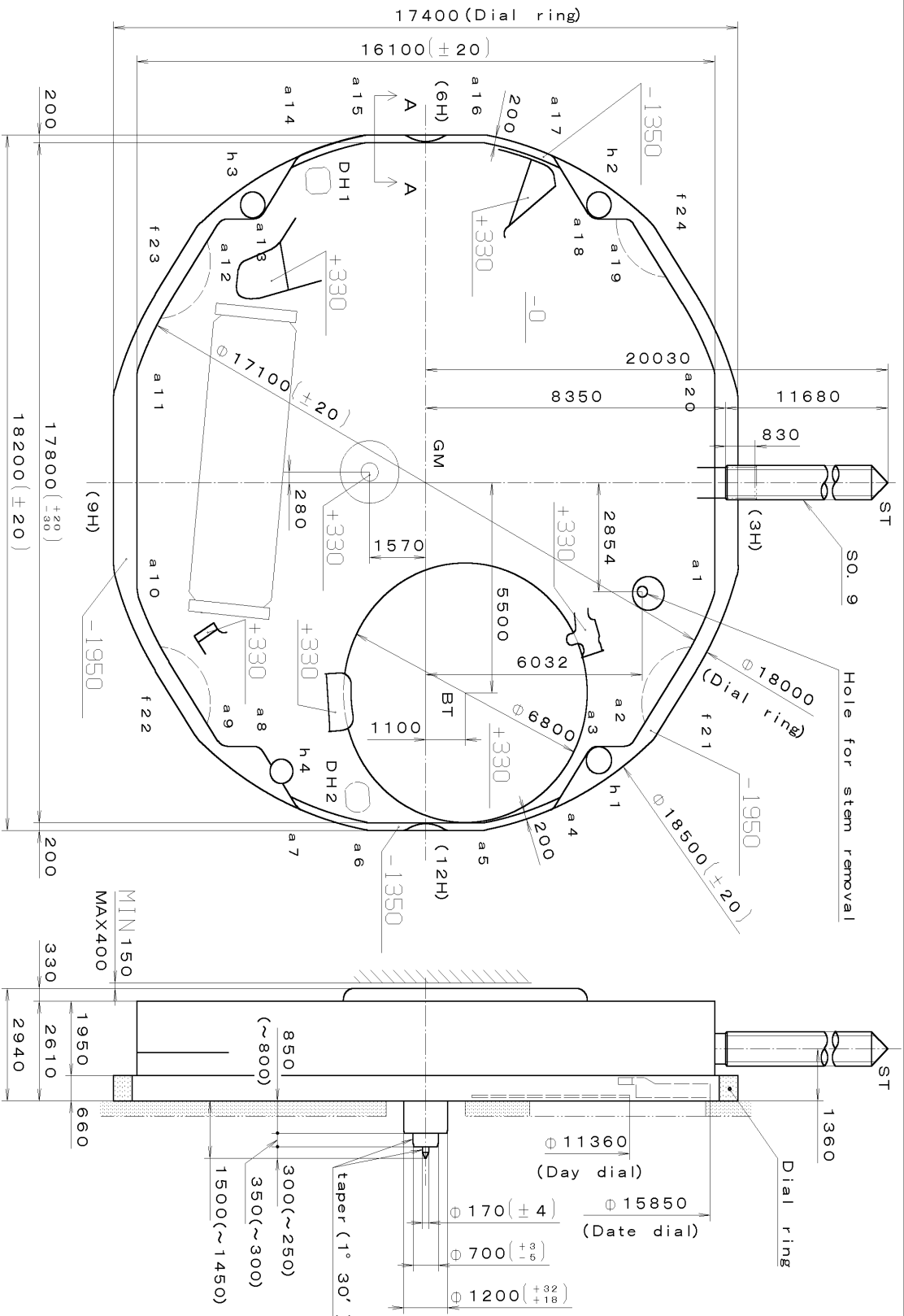

Quantity	Unit	Scale	Cal. No. :
1	1/1000 mm	9:1	1L02
Material			Parts:
Heat Treatment			Date
Hardness			Drawn
Plating			Checked
General Tolerances			Approved
Dimensions			T. Hiruta
Angles			Name:
			Frame for Case
			Drawing No. : 1L02C000

This drawing is provisional and subject to our reconfirmation and/or revision without notice.

\*\*\* T I P W (01) \*\*\* (2100 1121) 1L02-10A \*\*\* 00-06-12

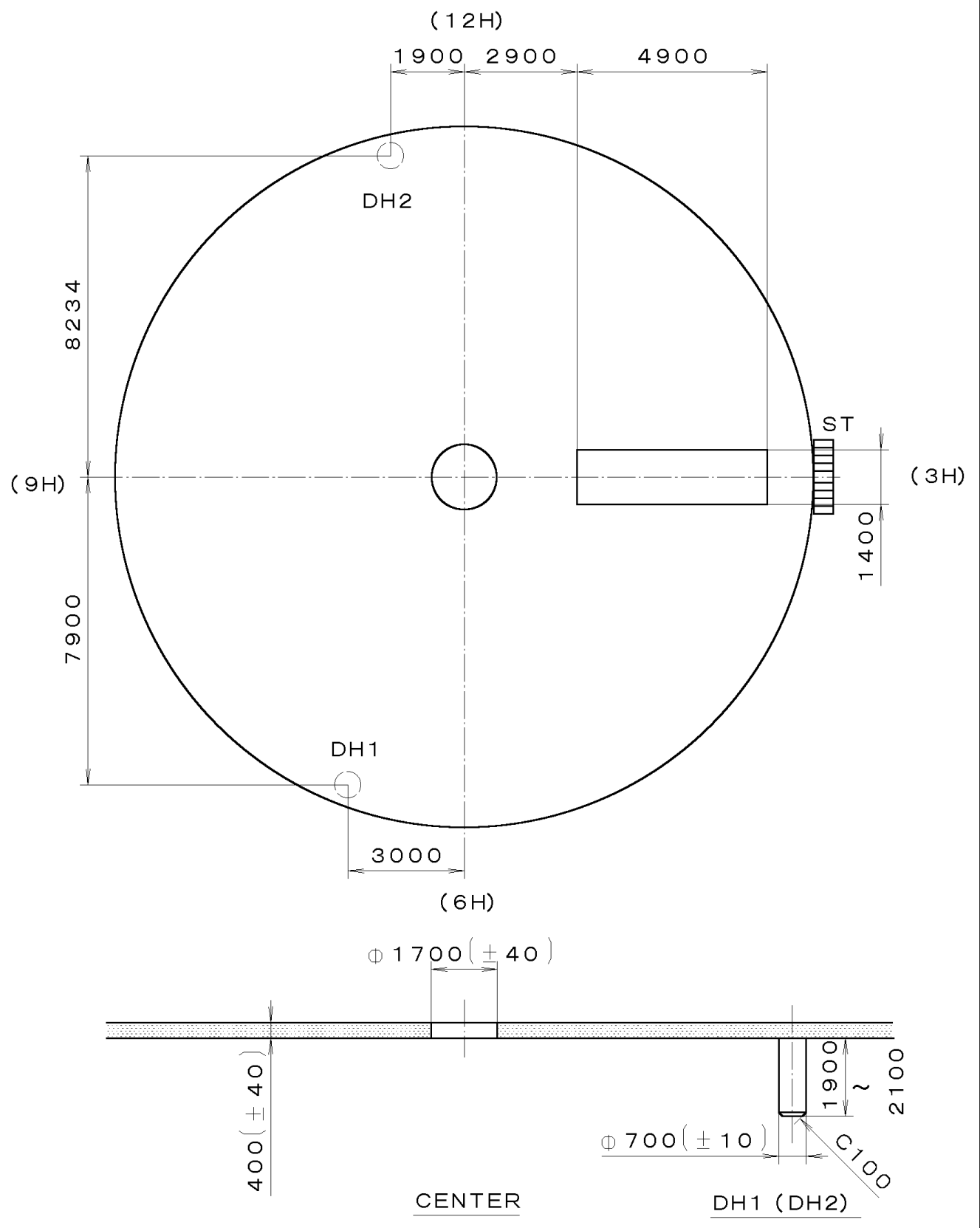

7		Quantity		Cal. No. :	1L02-10A
6		Unit	1/1000 mm	Parts:	
5		Scale	7:1	Name:	Indications for Dial
4		Date		Drawing No. :	1L02D000
3		Drawn			
2		Checked	T. Hiruta		
1		Approved			
Material					
Heat Treatment		General Tolerances			
Hardness		Dimensions			
Plating		Angles			

This drawing is provisional and subject to our reconfirmation and/or revision without notice.

\*\*\* T I P W (01) \*\*\* (2100 1121) 1L02-1AC \*\*\* 00-06-14

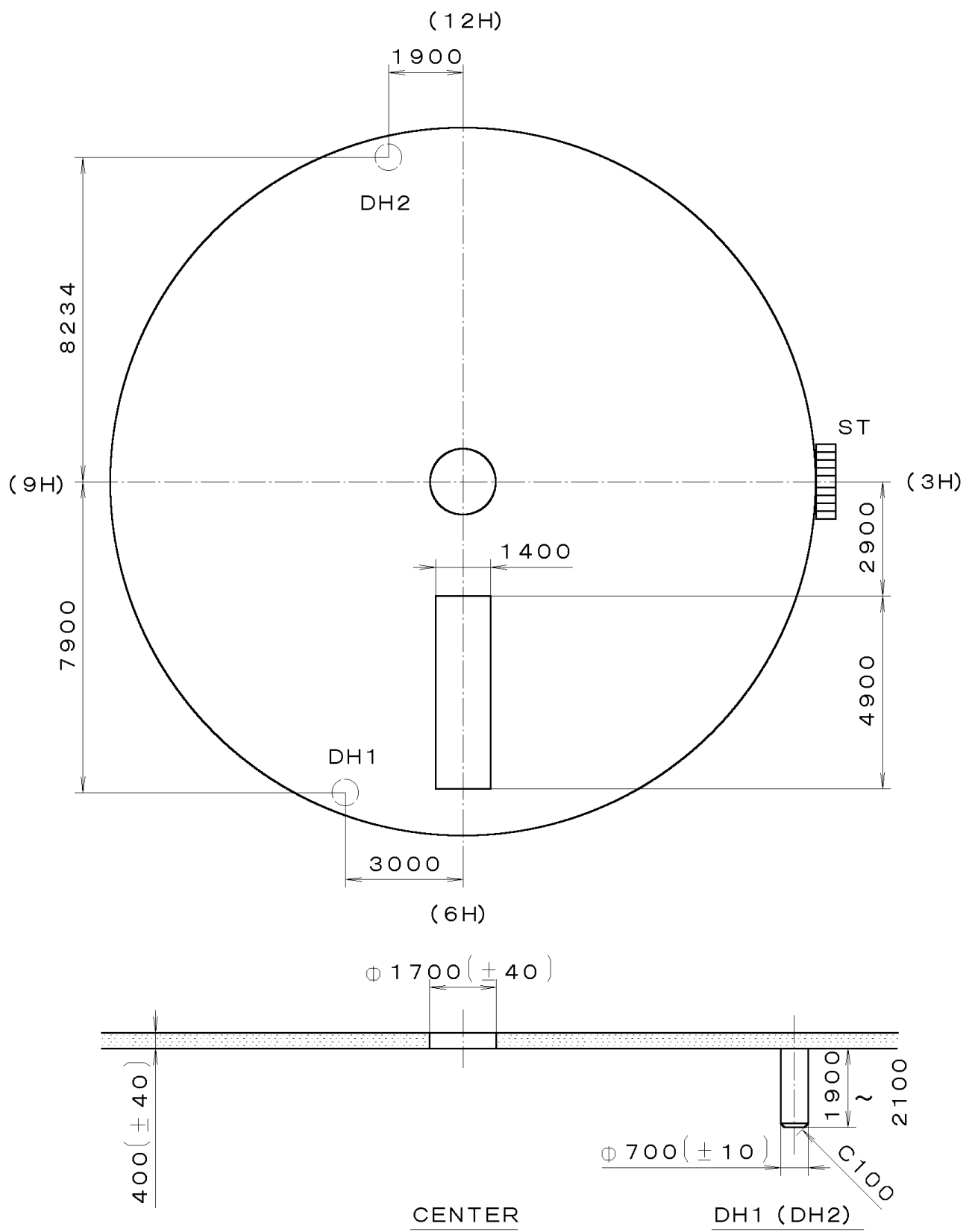

7		Quantity		Cal. No. :	1L02-1AC	
6		Unit	1/1000 mm	Parts:		
5		Scale	7:1	Name:	Indications for Dial	
4		Date		Drawing No. :		1L02D020
3		Drawn				
2		Checked	T. Hiruta			
1		Approved				
Material						
Heat Treatment		General Tolerances				
Hardness		Dimensions				
Plating		Angles				

This drawing is provisional and subject to our reconfirmation and/or revision without notice.

\*\*\* T I P W (01) \*\*\* (2100 1121) 1L02-1XZ \*\*\* 00-06-14

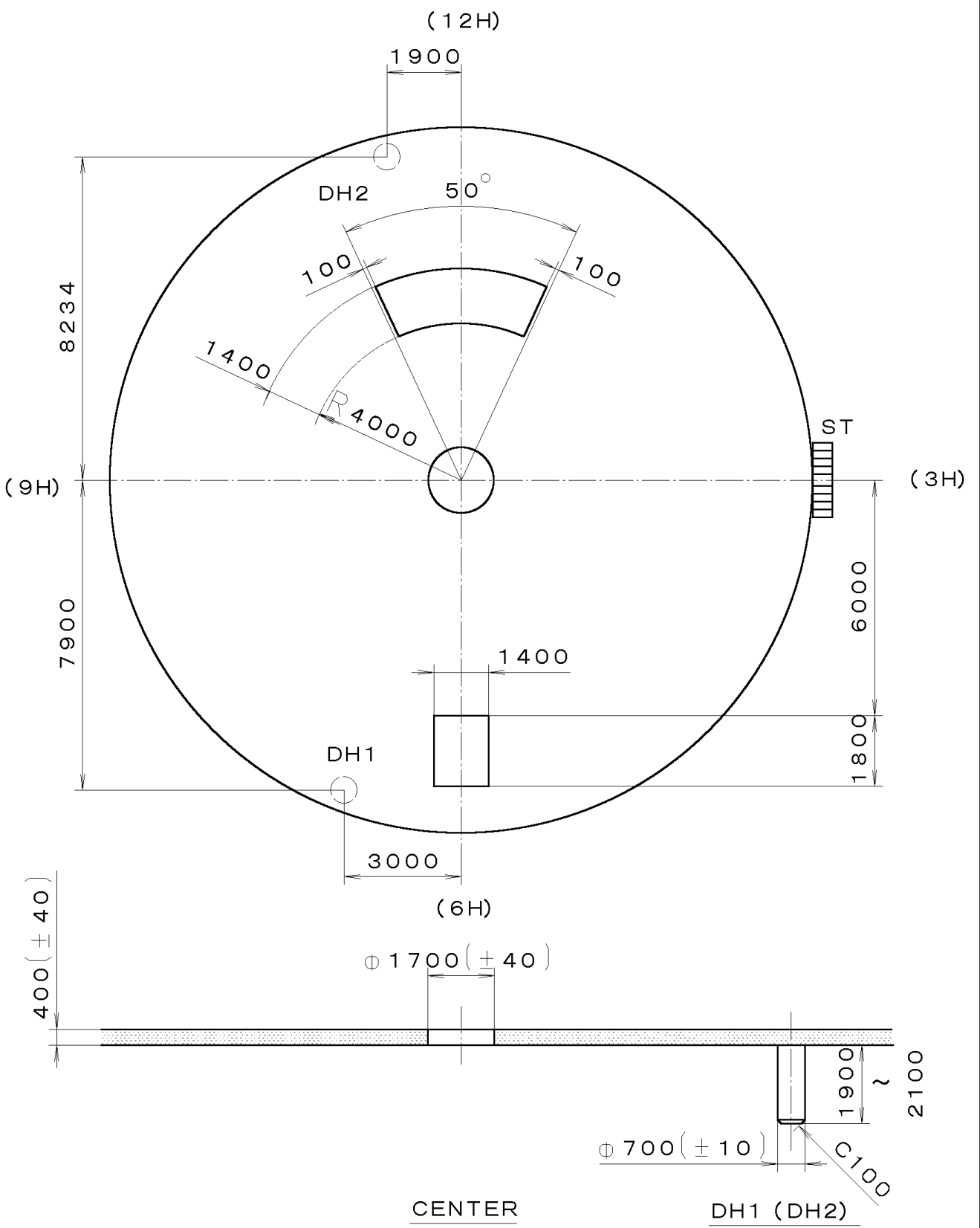

7		Quantity		Cal. No. :	1L02-1XZ
6		Unit	1/1000 mm	Parts:	
5		Scale	7:1	Name:	Indications for Dial
4		Date		Drawing No. :	1L02D030
3		Drawn			
2		Checked	T. Hiruta		
1		Approved			
Material					
Heat Treatment		General Tolerances			
Hardness		Dimensions			
Plating		Angles			

This drawing is provisional and subject to our reconfirmation and/or revision without notice.

\*\*\* T I P W (2100 1121) (01) \*\*\*  
 1L02-1AZ

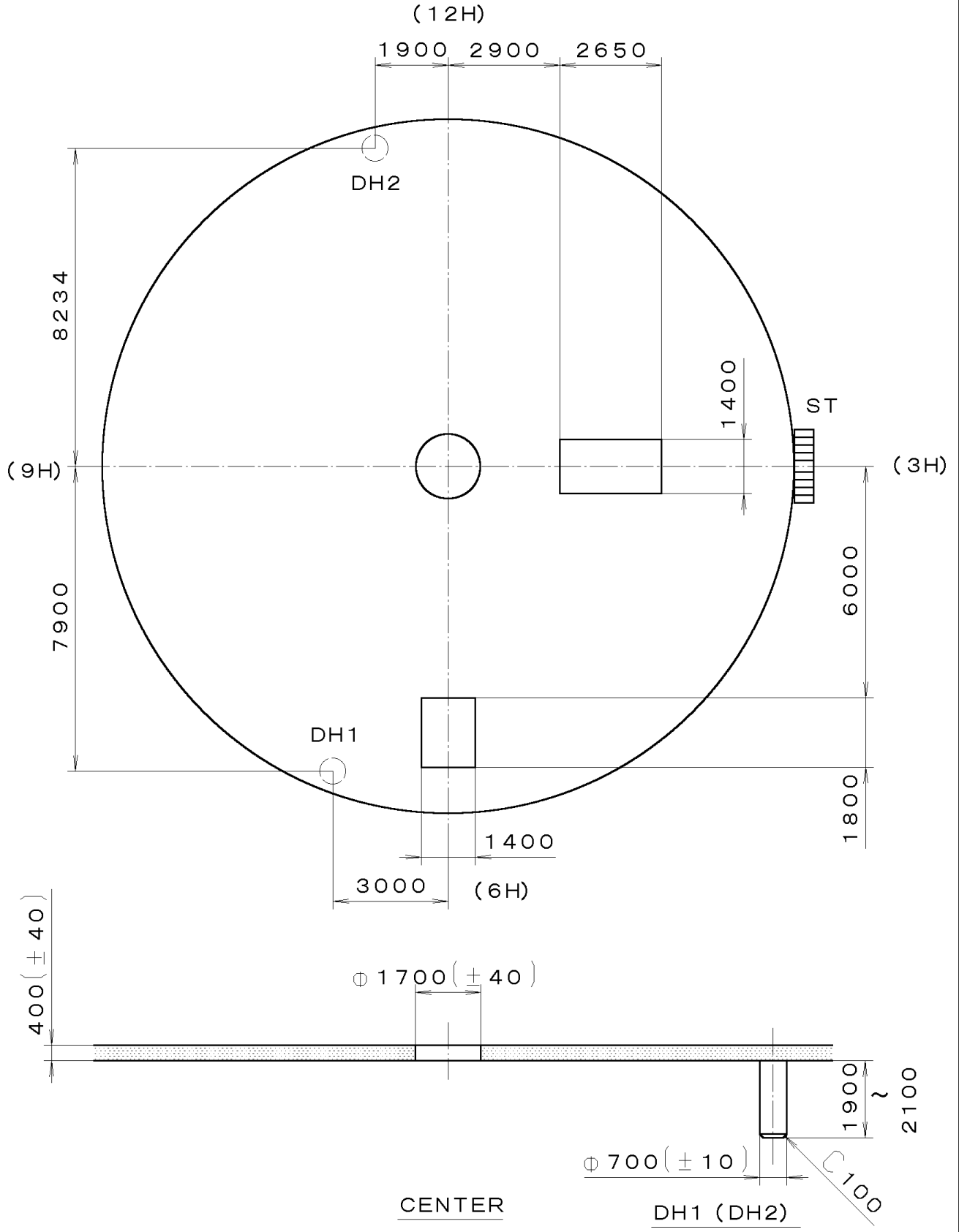

7		Quantity		Cal. No. :	1L02-1AZ
6		Unit	1/1000 mm	Parts:	
5		Scale	7:1	Name:	Indications for Dial
4		Date		Drawing No. :	
3		Drawn			
2		Checked	T. Hiruta		
1		Approved			
Material					
Heat Treatment		General Tolerances			
Hardness		Dimensions			
Plating		Angles			



This drawing is provisional and subject to our reconfirmation and/or revision without notice.

\*\*\* T I P W (01) \*\*\* (2100 1121 A-01 A-01 ) 00-06-22

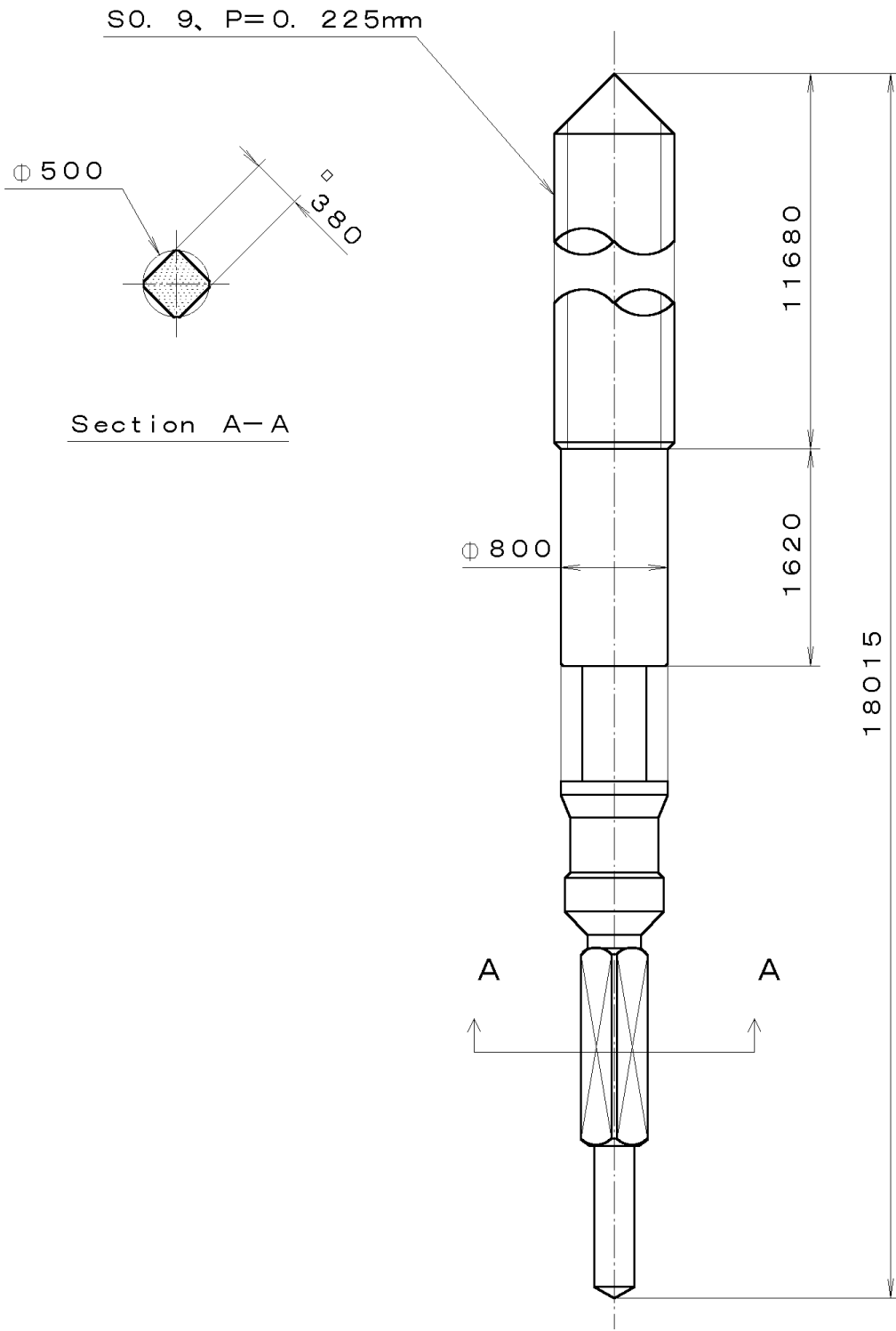

7			Quantity		Ca l. No. :
6			Unit	1/1000 mm	
5			Scale	20:1	Parts:
4			Date		065-505
3			Drawn		
2			Checked	T. Hiruta	Name:
1			Approved		SETTING STEM
Material					Drawing No. : 5050S000
Heat Treatment			General Tolerances		
Hardness			Dimensions		
Plating			Angles		



## INSTRUCTION MANUAL FOR MIYOTA WATCH MOVEMENT

BATTERY:

### INSTRUCTION MANUAL

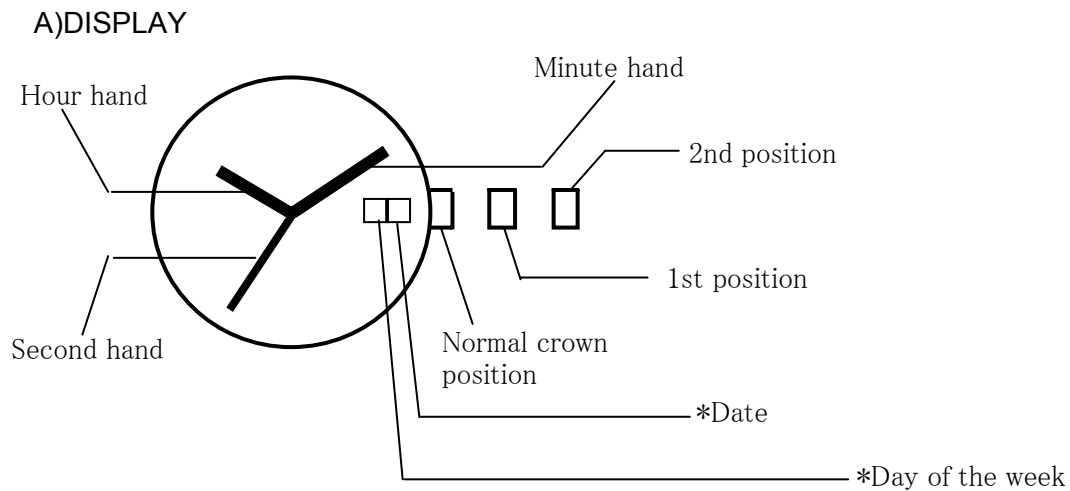

\*Date & Day of the week position may be located at different position depends on models.

### B) SETTING THE TIME

1. Pull the crown out to the 2nd position.
2. Turn the crown to set hour and minute hands.
3. When the crown is pushed back to the normal position, second hand begins to run.

### C) SETTING THE DATE

1. Pull the crown out to the 1st position.
2. Turn the crown counter-clockwise to set the date.  
\* If the date is set between the hours of around 9:00 PM and 1:00 AM, the date may not change on the following day.
3. After the date has been set, push the crown back to the normal position.

### D) SETTING THE DATE OF THE WEEK

1. Pull the crown out to the 1st position.
2. Turn the crown clockwise to set the day of the week.  
\* If the date is set between the hours of around 9:00 PM and 1:00 AM, the day of the week may not change the following day.
3. After the day of the week has been set, push the crown back to the normal position.